



L.E. Johnson Products, Inc.
 2100 Sterling Ave.
 Elkhart, IN 46516
 Ph: (574) 293-5664
 Fax: (574) 294-4697
 info@johnsonhardware.com
 www.johnsonhardware.com



111PD

Commercial Grade Pocket Door Hardware Set
 for 3/4" or Thicker Door to 80 lbs. (150 lbs. w/ 1025 Ball-Bearing Hanger)

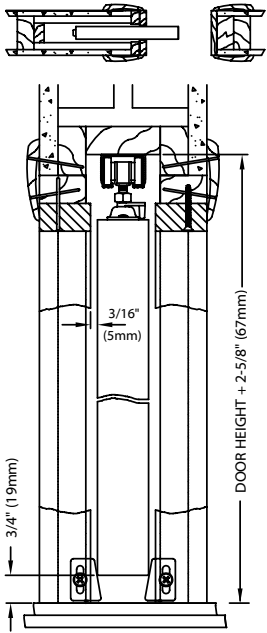

A versatile single track set designed and packed primarily for "on-the-job" construction of pocket doors, but also usable in combinations with itself or other Johnson series tracks for special installations of sliding doors. Components are available in bulk for fabricators, as are fixtures for assembly of pocket door frames.

111PD Features

COMMERCIAL GRADE ALUMINUM EXTRUDED TRACK

Heavy wall extrusions feature a convex track for one-point travel. "High-Lite" design of side walls hides finger marks and gives a decorative touch.

REMOVABLE TRACK

Track has keyhole slots for easy removal without tearing out walls. Box design prevents rollers from jumping track. Convex rails provide one-point wheel contact for smoothness and dirt traps for free rolling.

TRICYCLE HANGERS

Tri-design insures all wheels (3/4" dia.) carry weight equally. Machine turned, balanced wheels assure a smooth glide. Wheels ride on strong, permanently lubricated axles. Height is easily adjusted for perfect alignment. Hanger cannot jump out of the track. A "flip-of-a-clip" separates hangers from doors for easy door removal.

Track and Hardware Components



OPTIONAL 1025 HANGER

For doors up to 150 lbs. Ball bearing wheels provide smooth, quiet, easy operation of heavy doors.



Pocket Door Accessories



1521/1534 Privacy Lock

150 Edge Pull

21 Dummy Pull

40 Flush Pull

35 Flush Pull

1555 Converging Door Kit

1 3/4" Door Adaptor Kit

See online at: www.johnsonhardware.com/111PD.htm





INSTRUCTIONS

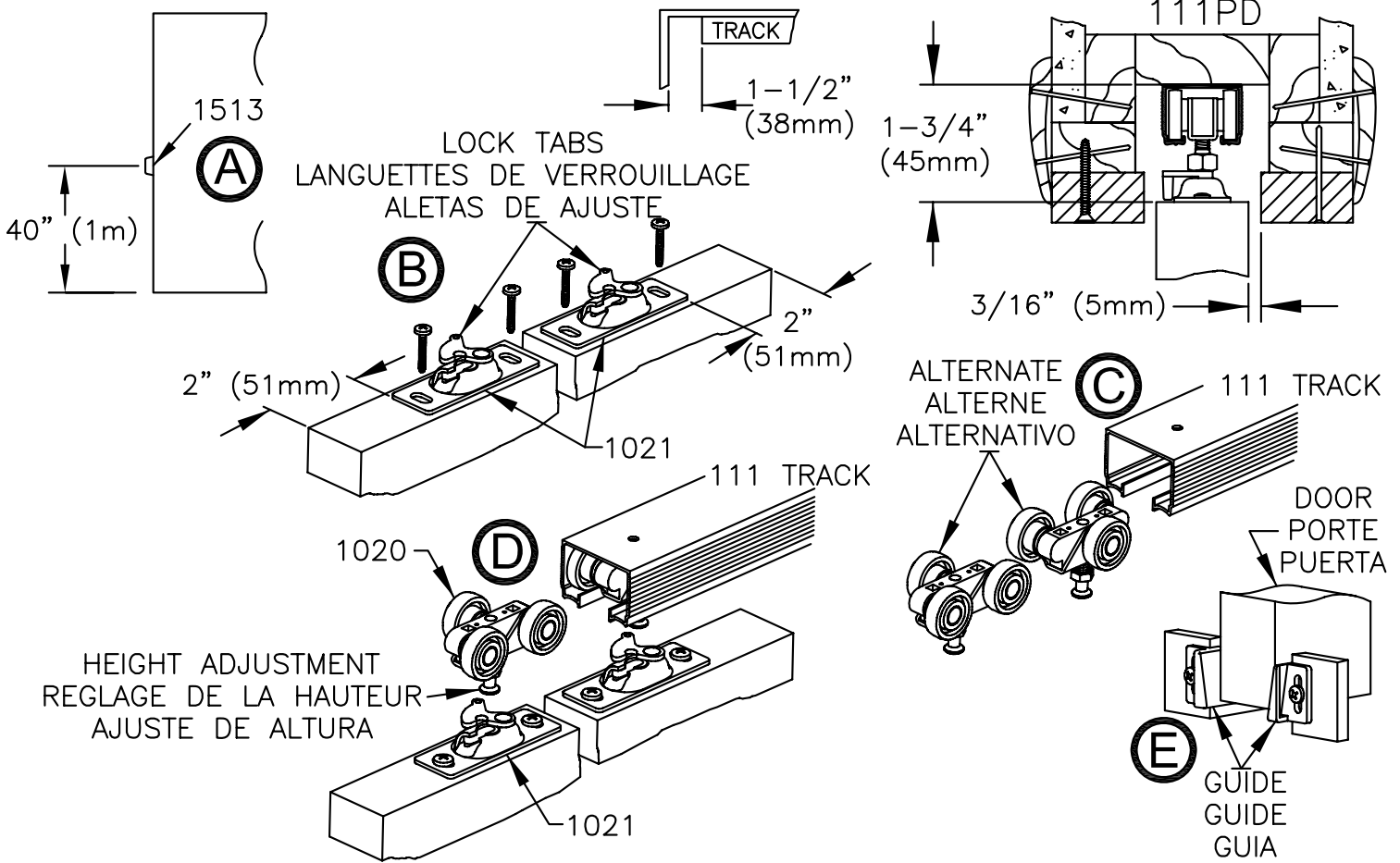

NOTE: Track must be level and square with jamb. Door must be sealed on all 6 sides.
A/Attach Bumper (1513) (if included) on back edge of the door 40" (1m) from bottom.
B/Attach Door Plates (1021) on top of the door 2" (50mm) from each edge with lock tabs on same side.
C/Insert Hanger (1020) into track alternating wheel positions for even weight distribution.
D/Mount Door by locating door plate (1021) under adjusting bolt of Hanger (1020) and tilting door until bolt will slide into seat of Door Plate (1021). Repeat with other Hanger/Door Plate. Adjust Hangers (1020) for height and plumb with jamb.
E/Attach Guides (1550) at bottom of opening and adjust so door is centered in opening.

NOTA: El riel debe estar nivelado y en escuadra con la jamba. La puerta debe estar sellada en todos los 6 lados.
A/Coloque el tope (1513) (si está incluido) sobre el borde trasero de la puerta a 1m desde abajo.
B/Coloque las placas de puerta (1021) sobre la puerta a 50mm de cada borde con las aletas de ajuste del mismo lado.
C/Coloque el colgador (1020) en la guía alternando las posiciones de la rueda para que el peso se distribuya parejo.
D/Instale la puerta ubicando la placa de la puerta (1021) debajo ajustando el perno del colgador (1020) e inclinando la puerta hasta que el perno se deslice asentándose en la placa de la puerta (1021). Repita con el otro colgador/placa de puerta. Ajuste los colgadores (1020) para obtener la altura y verticalidad con la jamba.
E/Coloque las guía (1550) abajo en la apertura y ajuste para que la puerta quede centrada al abrirla.

NOTE: La glissière doit être à niveau et perpendiculaire au montant. La porte doit être fermée sur ses 6 cotés.
A/Fixez la butée (1513) (si fournie) sur la tranche arrière de la porte à 1m du bas.
B/Fixez les attaches (1021) sur le haut de la porte à 50mm de chaque coin avec les languettes de verrouillage orientées du même côté.
C/Insérez les roulettes (1020) dans la glissière de manière alternée pour une répartition régulière du poids.
D/Assemblez la porte en positionnant l'attache (1021) sous la vis d'ajustement de la roulette (1020) et penchez la porte jusqu'à ce que la vis vienne se loger dans le siège de l'attache (1021). Répétez avec l'autre roulette/attache. Ajustez les roulettes (1020) pour la hauteur et vérifiez l'aplomb par rapport au montant.
E/Fixez les guides (1550) au bas de l'ouverture et ajustez la porte de sorte qu'elle soit centrée dans l'ouverture.