



www.johnsonhardware.com

# INSTRUCTIONS

## 1825FD SERIES FOLDING DOOR HARDWARE

For 1-1/8" (29mm) to  
1-3/4" (45mm) Panels  
weighing up to 30 lbs. (14kgs) each.

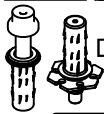
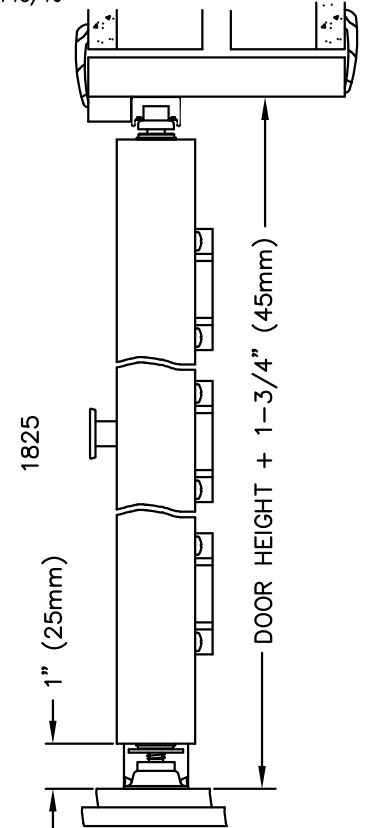
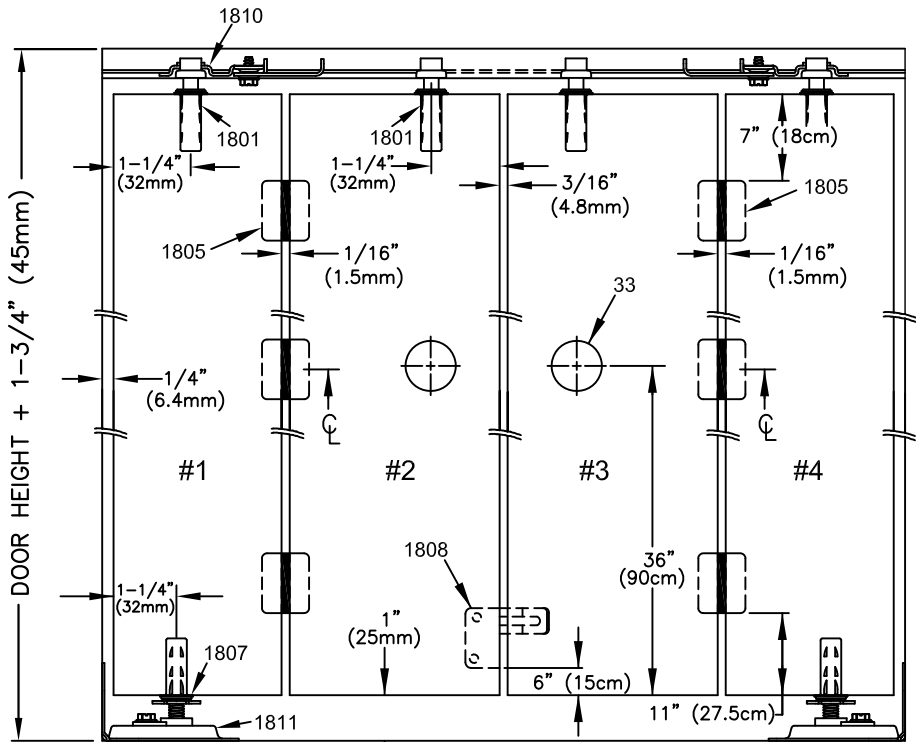
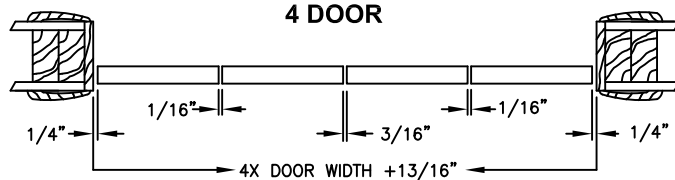
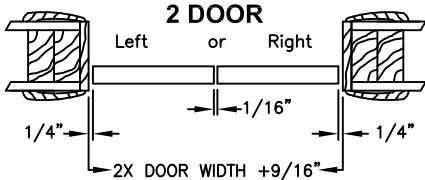

DRILL 7/16" (11mm) DIAMETER X 1-3/8" (35mm) DEEP - ALL PIVOT HOLES

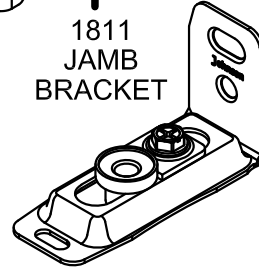
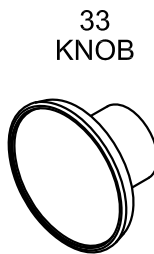
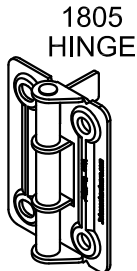
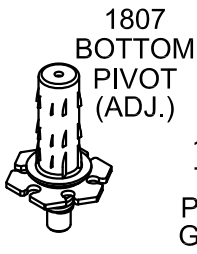
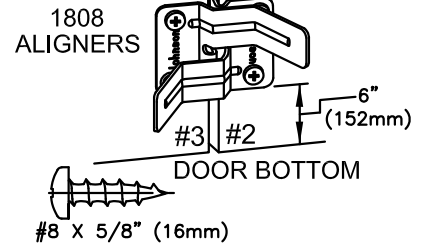
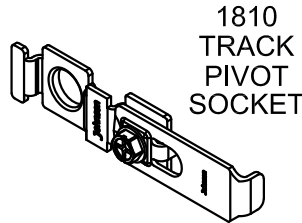
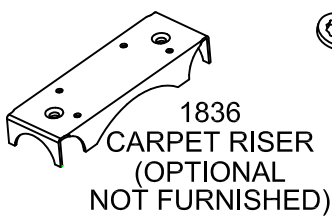



# INSTRUCTIONS

## 1825FD SERIES FOLDING DOOR HARDWARE

For 1-1/8" (29mm) to  
1-3/4" (45mm) Panels  
weighing up to 30 lbs. (14kgs) each.

If doors are not drilled for pivots and guides, drill 7/16" (11mm) diameter holes X 1-3/8" (35mm) deep, 1-1/4" (32mm) from edges and centered between door faces,

**TRACK** - Fasten to LEVEL head jamb 3/4" (19mm) from front edge. (For 2 door set, determine fold direction and mount track with Pivot Socket on desired fold.)

**JAMB BRACKET** - Mount 1811 Jamb Bracket to desired side Jamb, resting on floor. Pivot hole in bracket must be directly below hole in Track Pivot Socket. (if opening is carpeted, see use of optional 1836 Carpet Riser.

**HINGES** - (if not applied) Lay doors GOOD SIDE down, flat and even. Fasten 1805 Hinges 7" from top and 11" from bottom on BACK side. Center hinge is placed midway between other hinges.

**DOOR PIVOTS** - Tap fixed Pivot/Guide 1801 into holes in top edge of doors, and adjust Pivot 1807 into proper hole in bottom edge of either left or right door depending upon location of Jamb Bracket.

**ALIGNER** - (4 doors only) Fasten 1808 Aligner on BACK side of doors, 6" from bottom so fingers mesh when closed..

**KNOB** - Drill 3/16" (5mm) hole 36" from bottom of 2nd and 3rd doors (see A) centered on doors.

**MOUNT DOORS** - Insert Top Pivot into hole in Track Pivot Socket and Guide into track groove. Set Bottom Pivot into hole in Jamb Bracket Socket.

To minimize gap at top, lift doors to relieve pressure and turn adjusting nut on bottom pivot.

Close attention should be paid to the 1/4" (8mm) clearance between doors and side side jambs. If adjustment is required, loosen Pivot Socket or reposition bottom pivot block in Jamb Bracket.

**ADJUST SNUBBER 1713** - Close doors, slide 1713 until it touches 1801. Open doors, move 1713 1/8" (3mm) closer to 1801 and tighten. Doors should "SNAP" shut yet open easily by a slight pull on the knob.